

MR series

Rectangular Connectors

Outline

The MR series of connectors are small-sized rectangular connectors developed for data terminal equipment. The connector provides highly reliable flat terminals, and has been developed with a view of improving cost efficiency.

Features

- Provides a dual mechanism of screws and spring-locks to withstand any shock.
- Provides a dust-tight mechanism capable of withstanding environments.
- Best suited for downsizing equipment due to the robust smaller-size, lightweight, and high density.
- Provides a case for relay connections.

Principal Applications

Factory automation, communications equipment, data terminal equipment, instrumentation equipment, medical equipment, leisure electronic equipment, etc.

Electrical Characteristics

Rated voltage	300V AC (r.m.s.)
Rated current	3 A/pin
Insulation resistance	Over 1000 megohms (at 500V DC)
Dielectric withstanding voltage	1000V AC (r.m.s.)
Contact resistance	7 (30) milliohms or less The value enclosed within parentheses () is the contact resistance for right-angle type connectors.

Document Disclaimer

- When placing orders with us, minimum order quantities are set for every product.
- Be sure to contact us before starting preliminary design of PCBs using our connectors.
- The specifications and information shown in the catalog are subject to change without notice.

Recommended PCB layout for straight through hole type female connectors

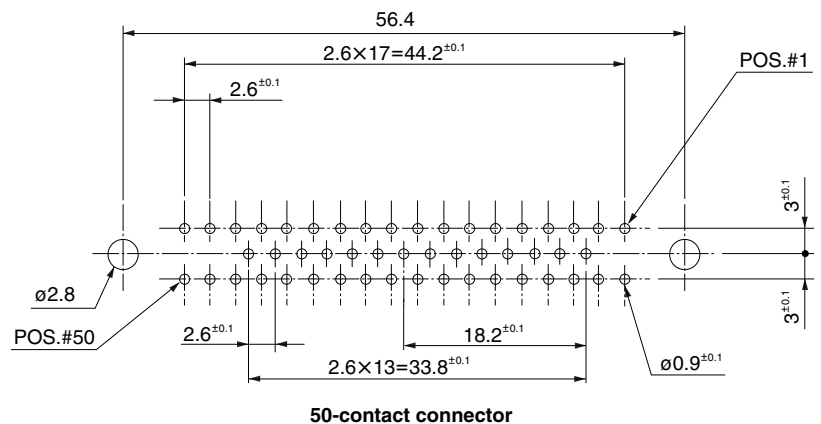
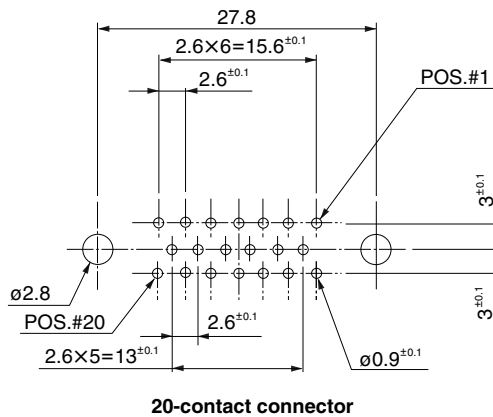
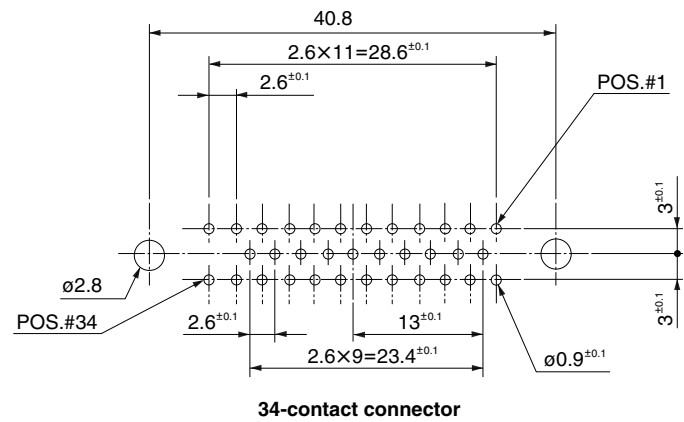
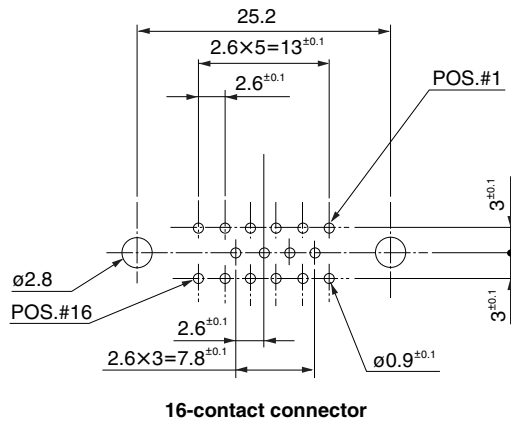
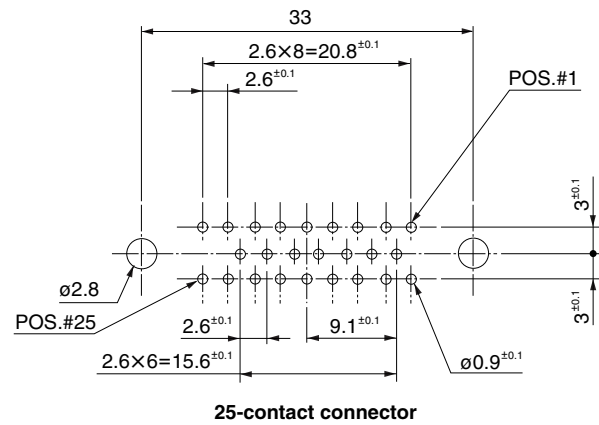
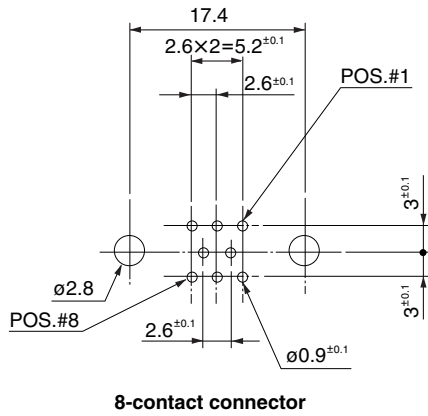

Note: The dimensions shown in these figures are on the PCB mounted face.

Recommended PCB layout for straight through hole type male connectors

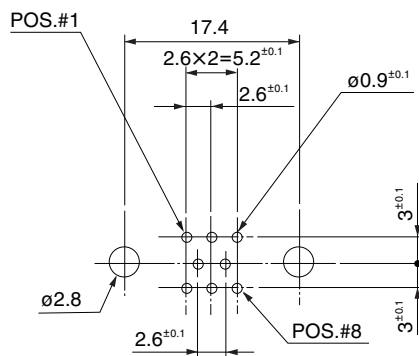

8-contact connector

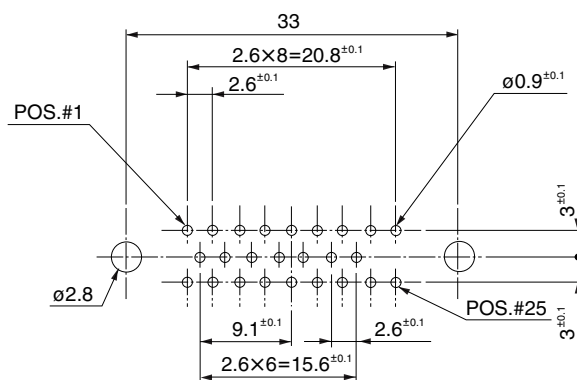

25-contact connector

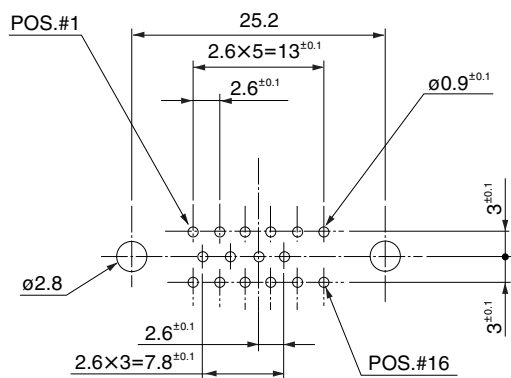

16-contact connector

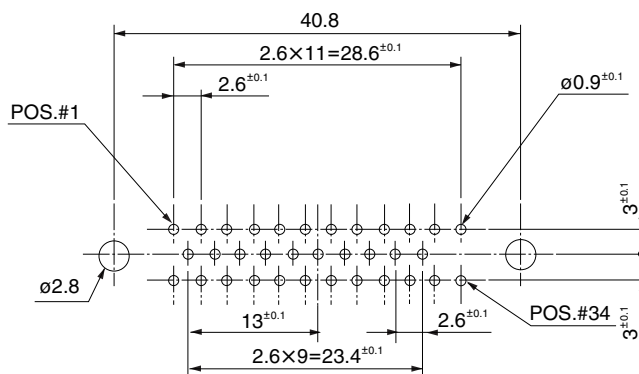

34-contact connector

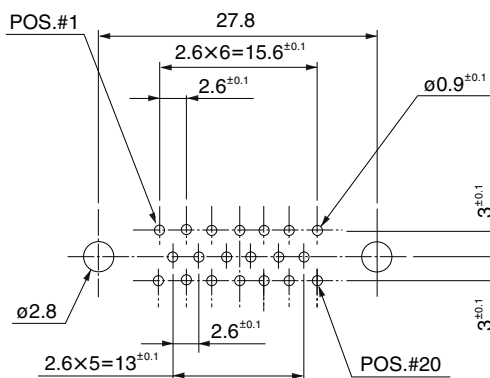

20-contact connector

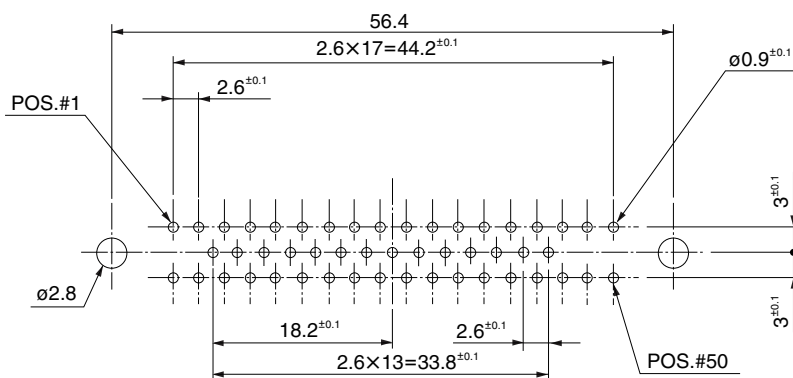

50-contact connector

Note: The dimensions shown in these figures are on the PCB mounted face.

Recommended panel cut-out dimensions for soldering type, wire wrapping or crimping type

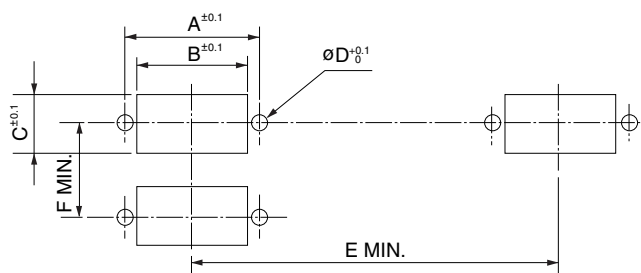

Recommended panel cut-out dimensions for soldering type, wire wrapping or crimping type

Connector	A	B	C	ϕD	E (Reference)	F
8-contact connector	17.4	12.4	11.5	2.8	63.6	20
16-contact connector	25.2	20.2			72.3	19
20-contact connector	27.8	22.8			74.9	
25-contact connector	33.0	28.0			80.1	20
34-contact connector	40.8	35.8			87.9	
50-contact connector	56.4	51.4	14.5	3.3	103.5	21
60-contact connector	52.6	46.8			98.7	23

Flow temperature profile (for reference purposes)

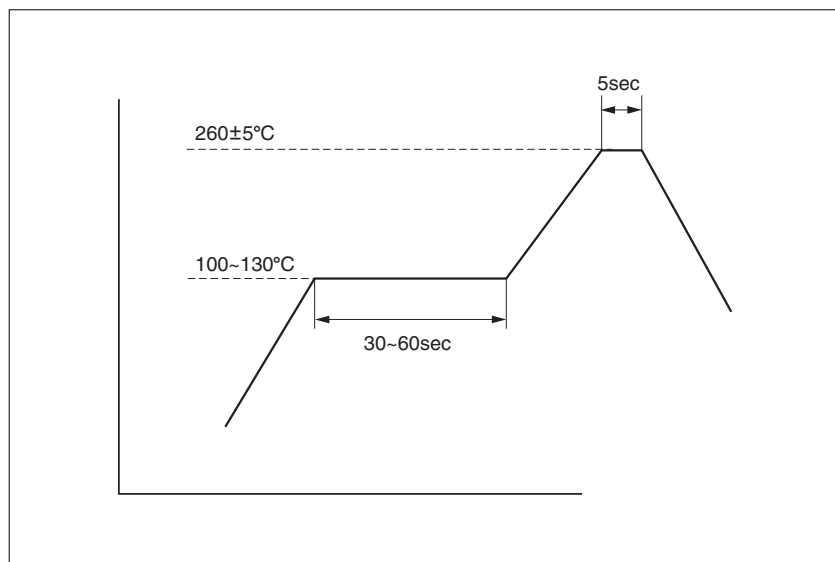

The flow temperature profile as shown above is for reference purposes. This profile depends on requirements such as the PCB size. Thus, this profile may not meet with your specific situation. Please evaluate your PCB-mounting soldering and set your own flow temperature profile.

●Applicable products

MR series through hole type connector

MRH series through hole type connector

MRF series through hole type connector

The profile shown in this drawing is applicable only for those products shown above.